



**S.N.D.T. Women's University**  
**Sir Vithaldas Thackersey College of Home Science**  
**(Autonomous)**

NAAC Re-accredited 'A' Grade

UGC Honor - College with Potential for Excellence



SVT/Quotation/2019-20/507

Date: 14.08.2019

SUB: Quotation for Proposed Interior Environmental Design Of Class Room 004 A on Ground Floor under RUSA -2 Infrastructure grant at Sir Vithaldas Thackersey College of Home Science (Autonomous) SNDT Women's University, Sir Vithaldas Vidyavihar Campus, Juhu Tara Road, Santacruz (West), Mumbai.

Madam /Sir,

Sealed quotations are invited for Proposed Interior Environmental Design Of Class Room 004 A on Ground Floor under RUSA -2 Infrastructure grant at Sir Vithaldas Thackersey College of Home Science (Autonomous) SNDT Women's University, Sir Vithaldas Vidyavihar Campus, Juhu Tara Road, Santacruz (West), Mumbai. Interested vendors are requested to submit their quote in the format given in Annexure A on company letter head. Quotation should be submitted to The Principal, Sir Vithaldas Thackersey College of Home Science (Autonomous) SNDT Women's University, Sir Vithaldas Vidyavihar Campus, Juhu Tara Road, Santacruz (West), Mumbai on or before 23<sup>rd</sup> August, 2019 (before 1.00 p.m.)

Sir Vithaldas Thackersey College of Home Science (Autonomous), SNDT Women's University, Santacruz (West), Mumbai reserves the right to reject any or all quotations without assigning any reasons thereof.

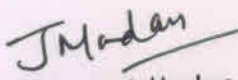
  
Dr. Jagmeet Madan  
(Principal)

(Offer should filled on letter head)  
Annexure A

To,  
The Principal,  
Sir Vithaldas Thackersey College of Home Science (Autonomous),  
SNDT Women's University,  
Juhu, Santacruz (West),  
Mumbai - 400 049.

SUB: Quotation for Proposed Interior Environmental Design Of Class Room 004 A on Ground Floor under RUSA -2 Infrastructure grant at Sir Vithaldas Thackersey College of Home Science (Autonomous) SNDT Women's University, Sir Vithaldas Vidyavihar Campus, Juhu Tara Road, Santacruz (West), Mumbai.

Respected Sir / Madam,

With reference to subject cited above we would like to furnish our quote with best rate possible as below :

ITEM NO.	DESCRIPTION OF ITEM	QTY	RATE (in Rs.)	UNIT	AMOUNT (in Rs.)
1	<b>FLOORING</b> Providing & laying approved make & shade vitrified floor tiles size :- 2'-0" x 2'-0" on 3/4" cement mortar (1:6) bedding in line & level as per design, specifications & instructions. Basic price of vitrified tiles : Rs. 50/- per sqft	575 Sqft		Sqft	
2	Providing & fixing in position 4" high approved make & shade vitrified tile skirting with cement mortar (1:4) backing including jud work in tile & plumb as per design, specifications & instructions. Basic price of vitrified tiles : Rs. 50/- per sqft	120 Rft	95/-	Rft	11,400/-
3	Providing & fixing in position partition fabricated out of 2" x 1 1/2" aluminium frame verticals & horizontals, 6mm thk approved make commercial ply on both sides including 1/24" (1mm) thk				

Cont-1



	approved make & shade laminate sheet on either side fixed on commercial ply with approved adhesive to 3"x 3/4" moulded T.W top etc angle with approved shade french polishing as per design, specifications & instructions.	55 Sqft	Sqft	
4	<u>DOOR</u> a) 3" x 4" TW framed & 1 1/2" thk solidcore approved make blockboard shutter having approved make & shade 1/24" (1mm) thk laminate fixed, 1 1/2" x 1" thk TW edging, including french polished edging etc., complete with necessary hardware & adhesive etc., all complete as per design, specifications & instructions.	21 Sqft	Sqft	
	b) Refurbishing existing framed shutter to other class room entry. Size: 4'-0" x 7'-0" ht	28 Sqft	Sqft	
5	<u>BLOCKING THE WINDOW</u> Providing & fixing 1/2" thk approved make commercial ply having 1/24" (1mm) thk approved make & shade laminate glued with approved adhesive, 1/2" x 1/2" TW edging etc., with approved shade french polish etc., complete as per design, specifications & instructions.	30 Sqft	Sqft	
6	<u>PELMET</u> Providing & fixing in position 6"x6" pelmet fabricated out of 1/2" thk approved make & quality commercial ply exposed outer surface finished with 1/24" (1mm) thk approved make & shade laminate shade etc., complete with approved white shade oil paint in 3 coats etc., all complete as per design, specification & instructions.			
7	Repairing & refurbishing existing windows with necessary approved make hardware including approved shade oil paint on both sides & cleaning the glass etc., complete as per design, specifications & instructions.	60 Sqft	Sqft	
8	Providing & applying 3/4" (20mm) thk 1:4 mix cement plaster one coat in shower area as per design, specifications & instructions.	250 Sqft	Sqft	
9	<u>BOXING OF A.C PIPING</u> Providing & fixing in position 7" x 2" fixed boxing with approved make 1/2" thk commercial ply including 1/2" thk approved make gypsum board on exposed surface etc. all complete as per design, specifications & instructions.	82 Sqft	Sqft	

10	<b>PAINTING</b>				
	a) Providing & applying approved make & shade painting to walls including sand papering, lambi, putty, primer etc., all complete as per instructions.	1700 Sqft		Sqft	
	b) Do-Do as above but enamel oil paint to doors & windows	150 Sqft		Sqft	
11	<b>ROLLER BLIND</b>				
	Providing, Supplying & fixing in position approved make & shade roller blind to windows as per instructions (2 Nos.)	46 Sqft		Sqft	
12	Miscellaneous		P/S		10,000/-
	<b>TOTAL</b>				

All the terms and conditions given in notifications are studied thoroughly and accepted fully.

Thanking you,

Yours truly,

Name of the Company  
Signature of the Proprietor  
Date :

- Note : Please enclose
1. Self attested GST number copy ,
  2. Self attested PAN number copy,
  3. Declaration on the company letter head if GST is not applicable.

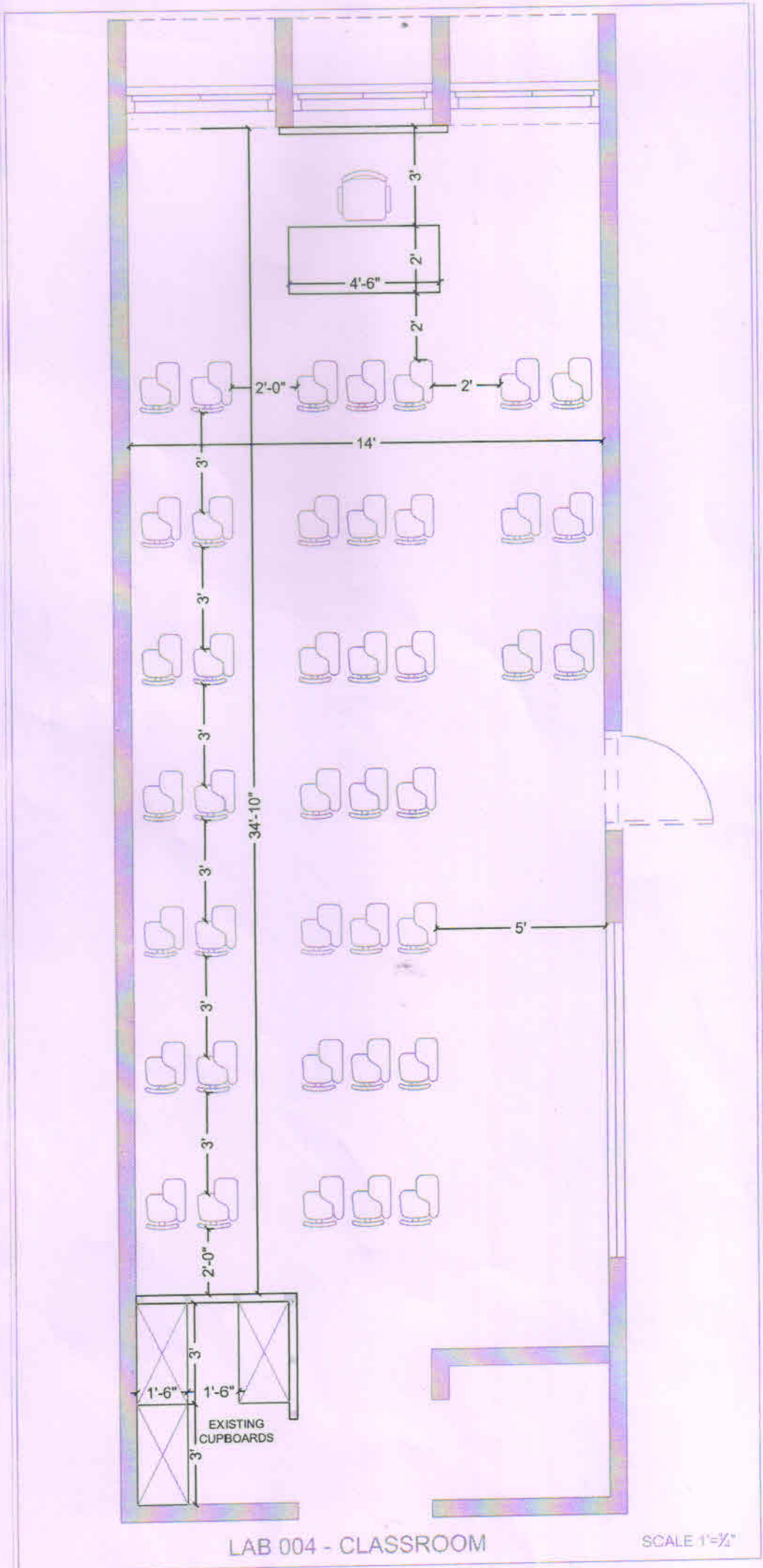

LAB 004 - CLASSROOM

SCALE 1"=1/2'